

Instructions for Replacing 1st Generation SmartNav / NavPlus with an APTIV radio

1. Remove existing head unit using radio removal tools.
2. Remove rubber bullet from the back of the existing head unit and install it onto the new APTIV radio.
3. Disconnect harnesses from the existing display. The display can either be removed or left in the dash to fill the hole. **The display will not be functional.**
4. Disconnect existing head unit adaptor harness from IP harness and remove.
 - a. Disconnect truck harness J1939 data link breakout connectors from adaptor and reconnect to each other.
 - b. **IF** the truck is equipped with premium audio:
 - i. Locate small black connector in adaptor harness labeled “P102 AMP SIGNAL” and disconnect from truck IP harness connector labeled “J01H AMP SIGNAL.” Locate loose small black connector on backside of ISO radio connector labeled “P01D AMP SIGNAL” and connect to “J01H AMP SIGNAL.” **THE AMPLIFIER WILL NOT FUNCTION IF THIS CIRCUIT IS NOT COMPLETED.**
 - ii. Locate small black connector in adaptor harness labeled “J101 AMP SENSE” and disconnect from the truck IP harness. Connect truck “AMP SENSE” to PP207130 jumper (sold separately). The yellow end of this harness will get connected to the radio.
5. **IF** installing a Bluetooth radio, install PP604240 microphone (sold separately) on A-Pillar as shown on next page and route the blue connector to the radio area.
6. Connect black 16-position ISO-DIN radio connector (J021) from IP harness directly into radio.
7. Connect the existing AM/FM cable (for an Aptiv radio use PP207262 Motorola to Fakra adapter), existing Satellite Radio antenna cable (if applicable to new radio), and new microphone cable (if applicable) to the radio, then install the radio into the dash. Ignore the existing GPS antenna connection.
8. Reassemble the dash panels.

Radio Retrofit: Verification

After installation is complete, verify operation of the following items:

1. AM/FM/WB radio: verify reception
2. SXM Satellite radio: verify reception

PP607144-001

<http://www.panapacific.com/support/download/>

Radio Retrofit: Microphone Installation

1. Remove the A-Pillar trim.
2. Clean the top of the A-Pillar trim using a 50/50 mix of isopropyl alcohol and water.
3. Install microphone on A-Pillar trim using adhesive tape on mic. Orient the microphone as shown in the picture below.
4. Route mic cable over top of A-Pillar trim, behind trim and down into IP.
5. Reinstall the A-Pillar trim.

Microphone



Microphone (installed)

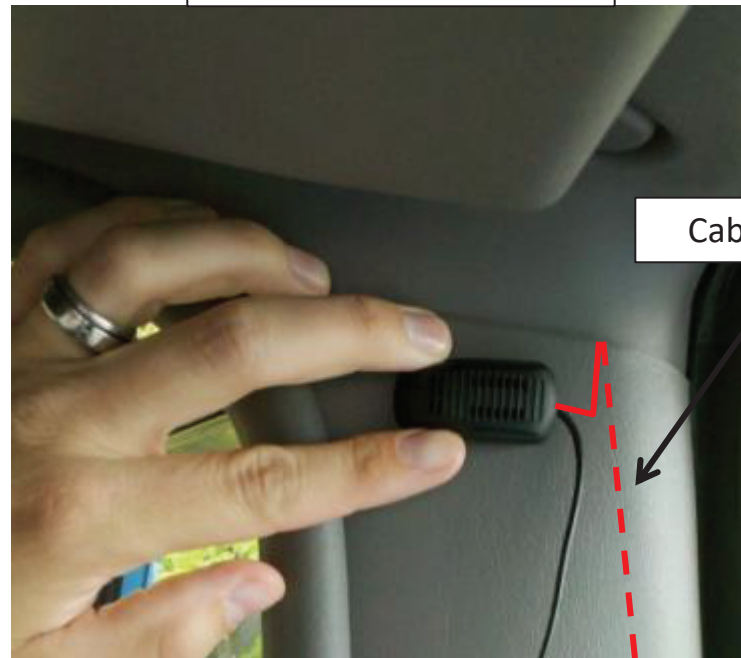

Cable Routing